



HSO/HSV/HSE

Hyosung Submersible Motor Pump



Springs of Living Water



I

HSO 용도 Application / 특징 Features	I 01
호칭 Model Designation / 표준 사양 Standard Specification	I 01
선정도 Selection Chart	I 02
조립 단면도 Sectional Drawing	I 03
외형도 & 외형 치수표 Outline Drawing & Dimension	I 03
HSV 용도 Application / 특징 Features	I 04
호칭 Model Designation / 표준 사양 Standard Specification	I 04
선정도 Selection Chart	I 05
조립 단면도 Sectional Drawing	I 06
외형도 & 외형 치수표 Outline Drawing & Dimension	I 06
기술 사항(탈착장치) Technical (Detachment Device)	I 07
기술 사항(Auto Cut) Technical (Auto Cut)	I 09
HSE 용도 Application / 특징 Features	I 10
호칭 Model Designation / 표준 사양 Standard Specification	I 10
선정도 Selection Chart	I 11
조립 단면도 Sectional Drawing	I 12
외형도 & 외형 치수표 Outline Drawing & Dimension	I 12
기술 사항(탈착장치) Technical (Detachment Device)	I 13
기술 사항(Auto Cut) Technical (Auto Cut)	I 15

HSO / HSV

Hyosung Submersible Motor Pump

용도 Application

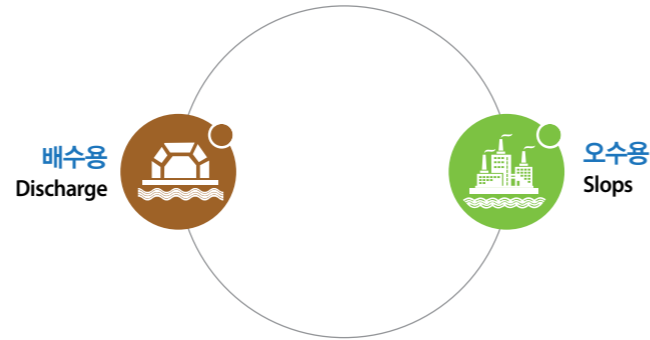

특징 Features

- | | |
|--|---|
| <ul style="list-style-type: none"> 01. 고효율의 Semi-Open 회전차를 사용하여 사용범위가 넓고, 높은 효율을 발휘함 02. Auto Cut을 부착하여 전동기의 과부하, 구속 등에 의한 전동기 소손 방지 03. 한국산업규격(KS B6321) 제품으로 규격과 품질을 표준화함 04. 흡입 스트레너 적용으로 고품질 유입 방지 및 회전차의 소손 방지 05. 축봉부에 SiC재질의 고신뢰성 메카니칼 씸을 장착하여 전동기 내부로의 침수 방지 06. 탈착장치 사용시 설치, 인양, 보수작업이 용이함 07. 고효율 기자재 | <ul style="list-style-type: none"> 01. Highly-efficient semi-open impeller for wide application and high efficiency 02. Auto cut to prevent the motor overload and stall 03. Specification and quality standardized to the Korean Industrial Standard (KS B 6321) certification 04. Suction strainer to prevent solid intake and impeller damage 05. Highly reliable SiC mechanical seal installed in the shaft to prevent water inflow to the inside of the motor 06. Detachable type for easy installation, lifting and maintenance 07. Highly Efficient Equipment |
|--|---|

호칭 Model Designation

50 HSO 6 1.5

토출구경 50 Discharge Diameter [mm]	펌프 모델명 HSO Model Name	주파수 6 Frequency [60Hz]	모터 동력 1.5 Motor Power [kW]
--	------------------------------------	-------------------------------------	---

표준 사양 Standard Specification

항목 Category		구경 Diameter	
		50	80 ~ 100
액질 Liquid	취급액	오수 (정화조 처리수) Waste Water 우수 Rainwater	
	온도	0 ~ 40°C	
	이물질 최대크기 Maximum Size of Solid Matter	펌프구경 10%정도의 고품물 10% of the Discharge Diameter	
회전수	R.P.M	3500	
회전방향	Rotation Direction	CW (구동기 측에서 펌프를 바라보았을 때) (From the Motor Side to the Pump)	
모터 Motor	상/전압	Phase / Voltage	3Φ / 380V
	주파수	Frequency	50, 60Hz
	절연등급	Insulation	IP68
	기동방식	Starting Type	직기동 Direct
축봉장치	Shaft Seal	Double Mechanical Seal	
배관 접속규격	Piping Connection	PT	KS 10K RF
전동기 보호장치	Motor Protection Device	Auto Cut	
체인 / 케이블	Chain / Cable	5m (SWRM8) / 7m	

선택사양 Option

- 재질 (SS13, 14, 16)
 - 고효율 수중펌프
 - 자동탈착장치
 - 인양체인 규격 및 케이블 길이
 - 가이드파이프, 자동제어반
 - 도장사양 (요구사항)
 - 전동기 전압 (220, 400 ~ 480V)
-
- Material (SS13, 14, 16)
 - Highly Efficient Submersible Pump
 - Automatic Detachment Device
 - Lifting Chain Specification and Cable Length
 - Guide Pipe, Automatic Control Panel
 - Painting Specification (Requirement)
 - Motor Voltage (220, 400~480V)

선정도 Selection Chart

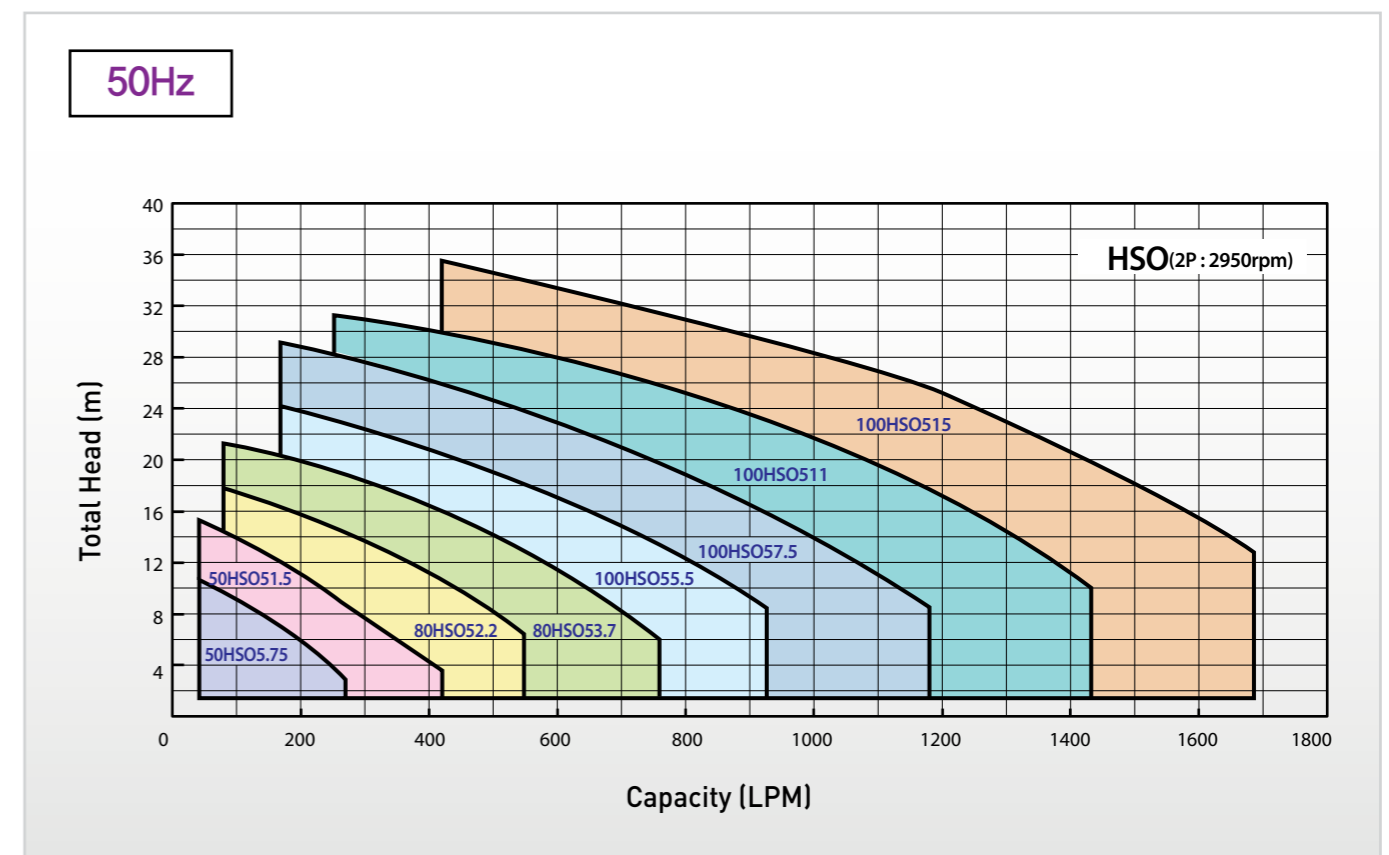
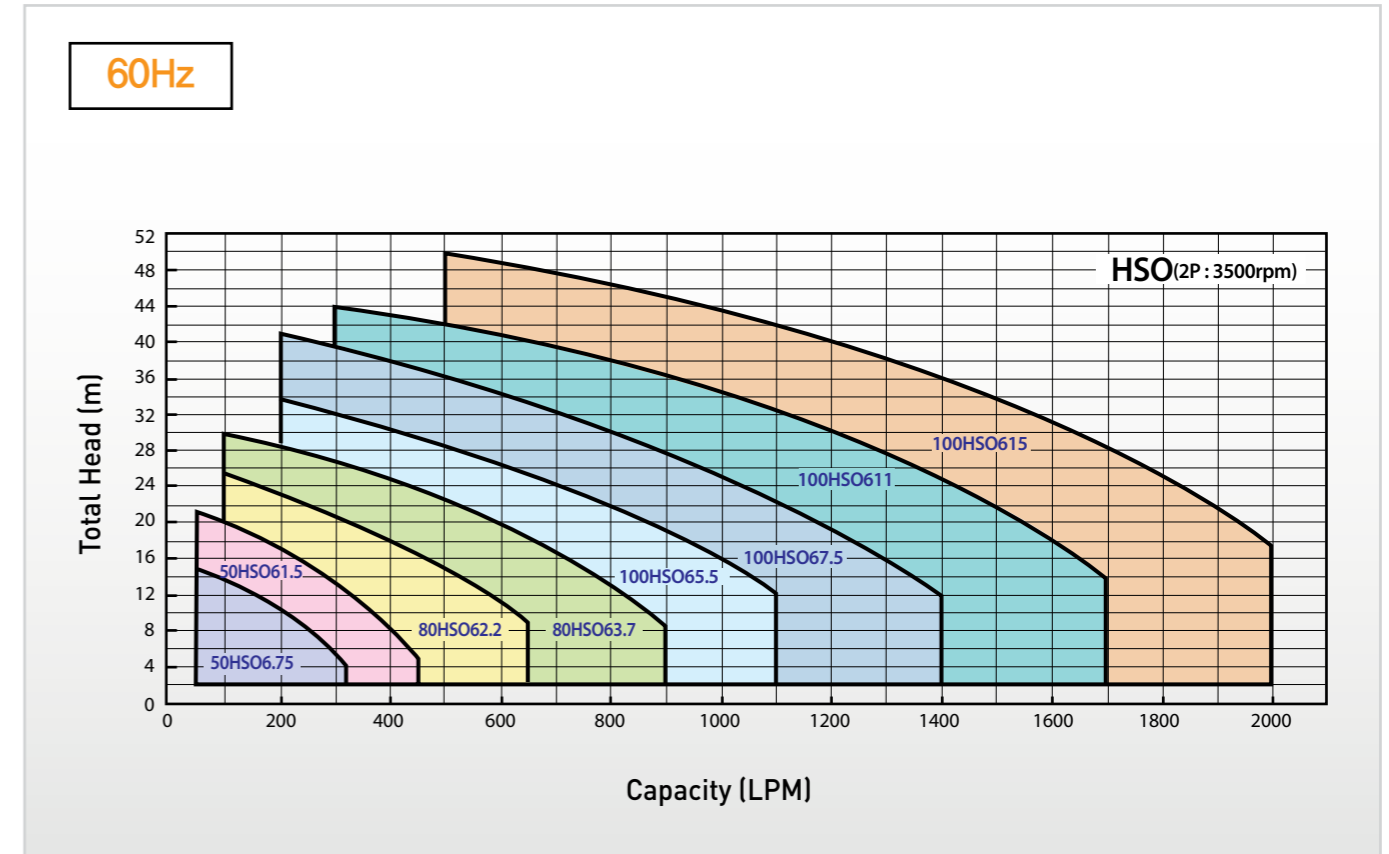

HSO / HSV

Hyosung Submersible Motor Pump

조립 단면도 Sectional Drawing

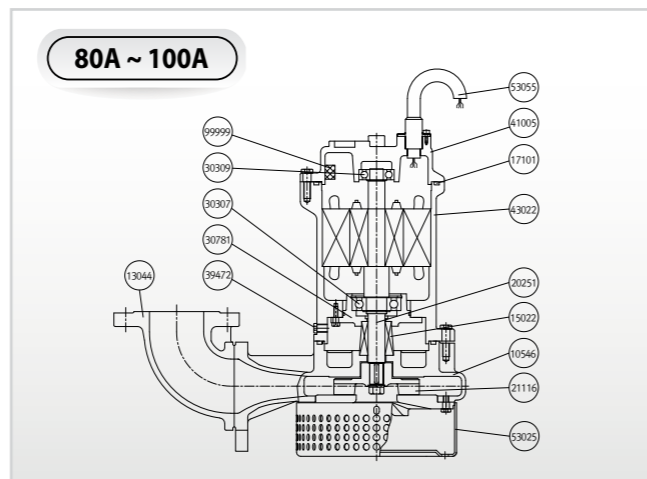
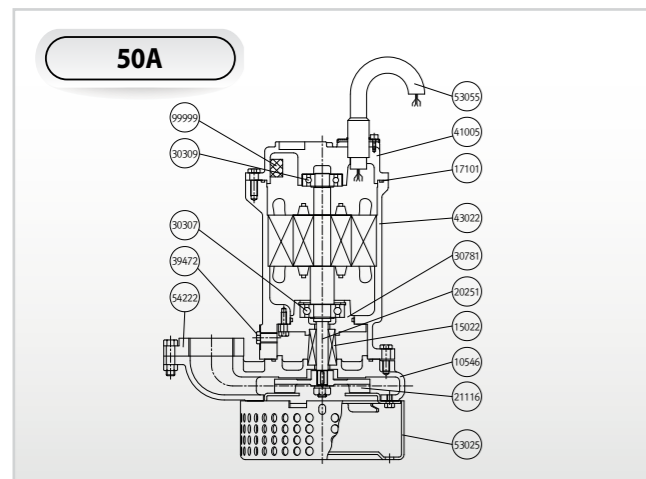

Part No.	부품명 Part Name	표준재질 Standard Material
10546	Casing	GC200
54222	Companion Flange	GC200
13044	Elbow	GC200
15022	Mechanical Seal	SiC/SiC
17101	O-Ring	N.B.R
20251	Shaft	STS410
21116	Impeller	GC200
30307	Ball Bearing	-

Part No.	부품명 Part Name	표준재질 Standard Material
30309	Ball Bearing	-
30781	Bearing Housing	GC200
39472	Plug	SM25C
41005	Motor Cover	GC200
43022	Motor Frame	GC200
53025	Strainer	SS275
53055	Cable	-
99999	Auto Cut	-

※ GC200 : Cast Iron / SM25C : Carbon Steel / STS410 : Stainless Steel / SS275 : Steel Structural

외형도 & 외형 치수표 Outline Drawing & Dimension

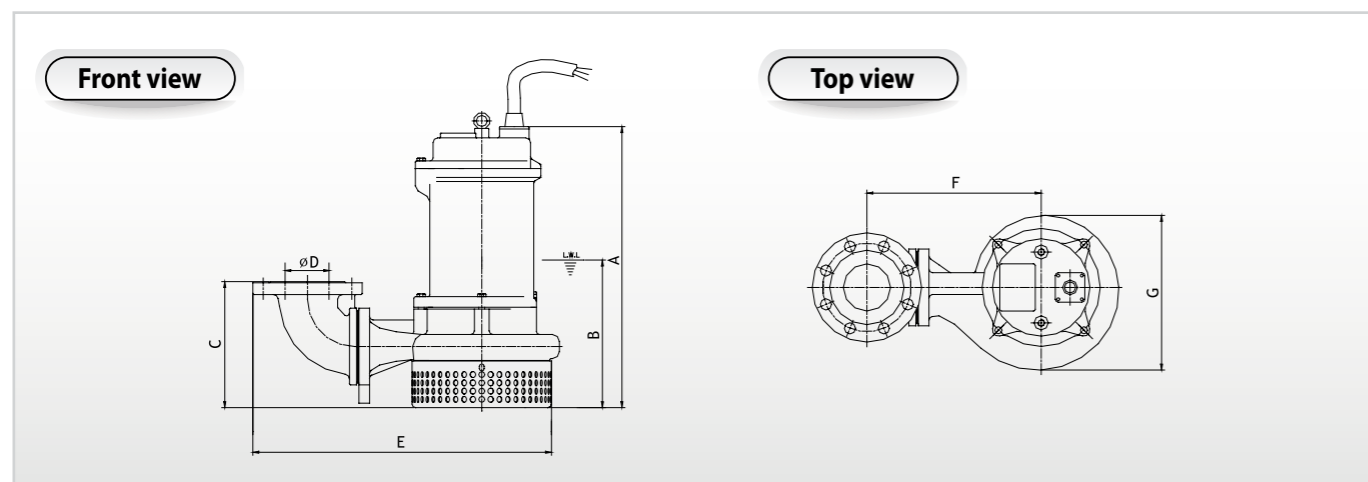

Model	A	B	C	D	E	F	G
50HSO6.75, 50HSO5.75	376	170	142.5	50	264	130	193
50HSO61.5, 50HSO51.5	414	170	142.5	50	264	130	193
80HSO62.2, 80HSO52.2	476	250	213.5	80	505	295	262
80HSO63.7, 80HSO53.7	501	250	213.5	80	505	295	262
100HSO65.5, 100HSO55.5	550	250	259	100	588	355	309
100HSO67.5, 100HSO57.5	575	250	259	100	588	355	309
100HSO611, 100HSO511	650	250	259	100	588	355	309
100HSO615, 100HSO515	670	250	259	100	588	355	309

Unit : mm

용도 Application

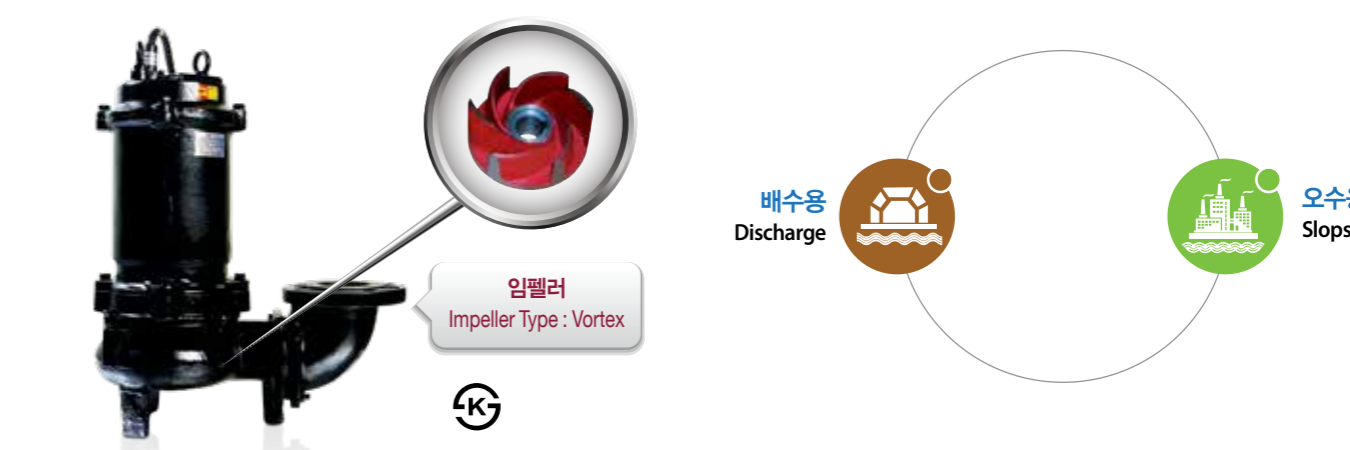

특징 Features

- 고효율의 Voltex회전자를 사용하여 큰 고형물이 있는 오수 이송에 적합
- Auto Cut을 부착하여 전동기의 과부하, 구속 등에 의한 전동기 소손 방지
- 한국산업규격(KS B6321) 제품으로 규격과 품질을 표준화함
- Hanger가 달려 있어 운반 및 탈착장치 부착 용이
- 축봉부에 SiC재질의 고신뢰성 메카니칼 씰을 장착하여 전동기 내부로의 침수 방지
- 탈착장치 사용시 설치, 인양, 보수점검이 용이함

- Highly efficient vortex impeller to transfer waste water with large solid matters
- Auto cut to prevent from the motor overload and stall
- Specification and quality standardized to the Korean Industrial Standard (KS B 6321) certification
- Hanger for easy transportation and detachment
- Highly reliable SiC mechanical seal installed in the shaft to prevent water inflow to the inside of the motor
- Detachable type for easy installation, lifting and maintenance

호칭 Model Designation

호칭 Model Designation

50 HSV 6 1.5

토출구경

50

Discharge Diameter [mm]

펌프 모델명

HSV

Model Name

주파수

6

Frequency [60Hz]

모터 동력

1.5

Motor Power [kW]

표준 사양 Standard Specification

항목 Category	구경 Diameter		
	50	80 ~ 100	
액질 Liquid	취급액 Applicable Liquid	고형물 함유액 Liquid with Solid Matters	
	온도 Temperature	0 ~ 40°C	
	이물질 최대크기 Maximum Size of Solid Matter	직경 Diameter(mm)	32 56
		길이 Length(mm)	150 200
회전수 R.P.M	3500		
회전방향 Rotation Direction	CW (구동기측에서 펌프를 바라 보았을 때) (From the Motor Side to the Pump)		
모터 Motor	상/전압 Phase / Voltage	3Φ / 380V	
	주파수 Frequency	50, 60Hz	
	절연등급 Insulation	IP68	
	기동방식 Starting Type	직기동 Direct	
축봉장치 Shaft Seal	Double Mechanical Seal		
배관 접속규격 Piping Connection	PT	KS 10K RF	
전동기 보호장치 Motor Protection Device	Auto Cut		
체인 / 케이블 Chain / Cable	5m (SWRM8) / 7m		

선택사양 Option

- 재질 (SSC13, 14, 16)
- 고효율 수중펌프
- 자동탈착장치
- 인양체인 규격 및 케이블 길이
- 가이드파이프, 자동제어반
- 도장사양 (요구사항)
- 전동기 전압 (220, 400 ~ 480V)
- Material (SS13, 14, 16)
- Highly Efficient Submersible Pump
- Automatic Detachment Device
- Lifting Chain Specification and Cable Length
- Guide Pipe, Automatic Control Panel
- Painting Specification (Requirement)
- Motor Voltage (220, 400~480V)

HSO / HSV

Hyosung Submersible Motor Pump

선택도 Selection Chart

60Hz

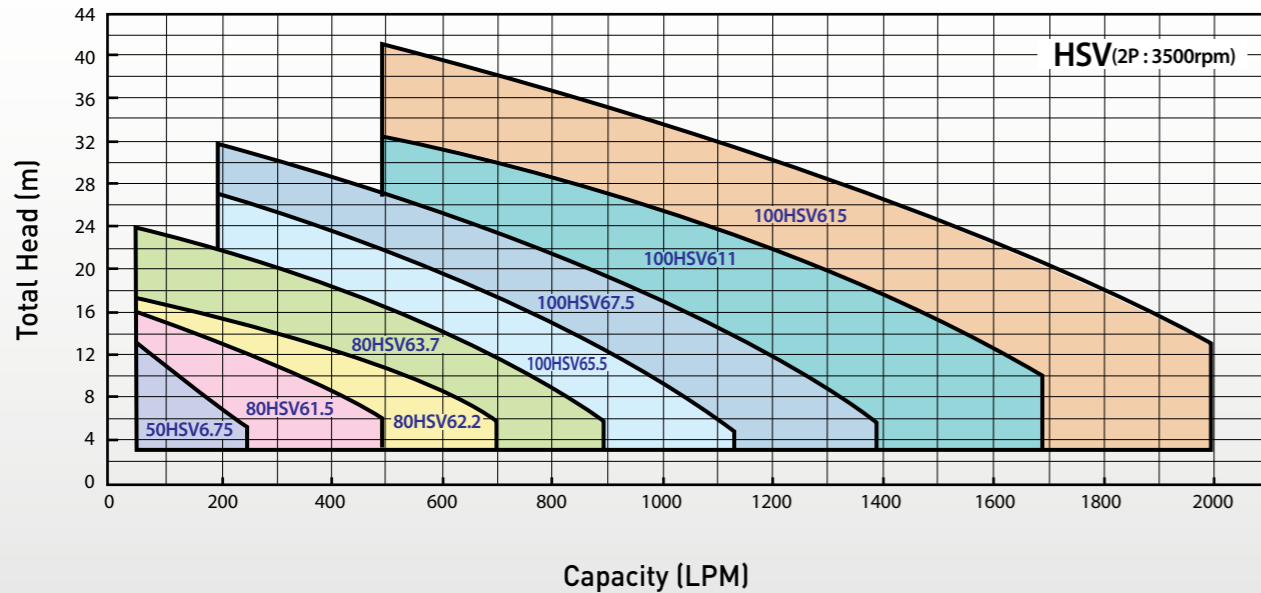

50Hz

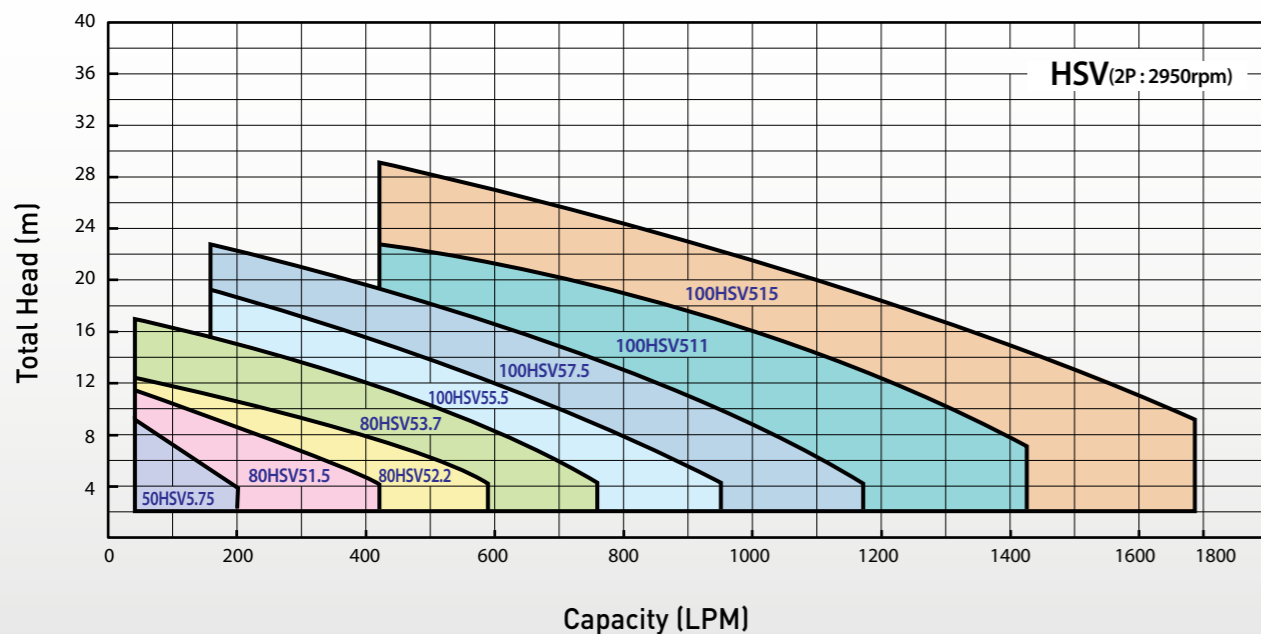

조립 단면도 Sectional Drawing

50A

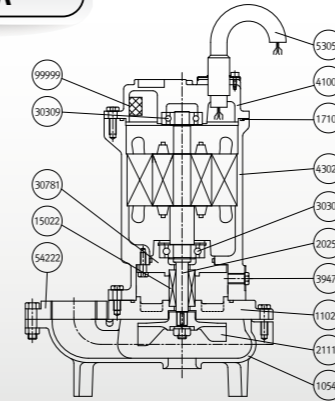

Part No.	부품명 Part Name	표준재질 Standard Material
10546	Casing	GC200
11029	Bracket	GC200
54222	Companion Flange	GC200
13044	Elbow	GC200
15022	Mechanical Seal	SiC/SiC
17101	O-Ring	N.B.R
20251	Shaft	STS410
21116	Impeller	GC200

80A ~ 100A

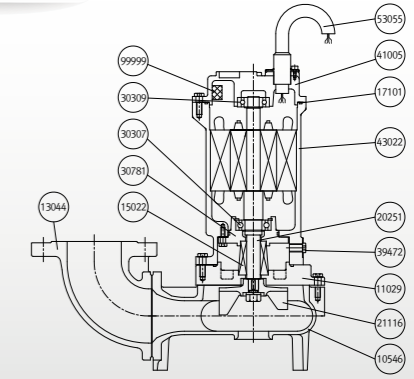

Part No.	부품명 Part Name	표준재질 Standard Material
30307	Ball Bearing	-
30309	Ball Bearing	-
30781	Bearing Housing	GC200
39472	Plug	SM25C
41005	Motor Cover	GC200
43022	Motor Frame	GC200
53055	Cable	-
99999	Auto Cut	-

※ GC200 : Cast Iron / SM25C : Carbon Steel / STS410 : Stainless Steel / SS275 : Steel Structural

외형도 & 외형 치수표 Outline Drawing & Dimension

Front view

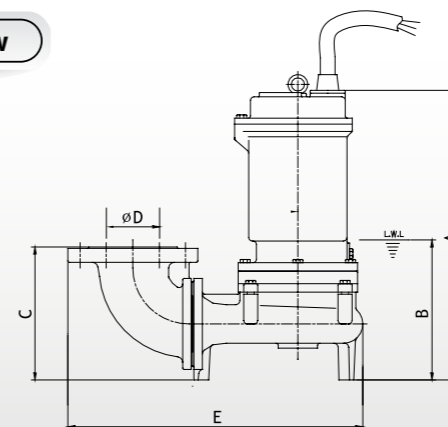

Top view

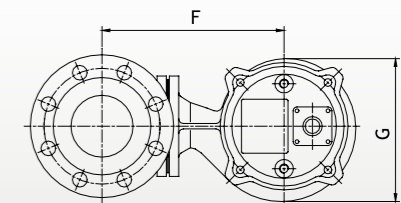

Model	A	B	C	D	E	F	G
50HSV6.75, 50HSV5.75	370	170	110	50	249	125	171
80HSV61.5, 80HSV51.5	440	200	190	80	420	235	185
80HSV62.2, 80HSV52.2	506	220	210	80	461	255	227
80HSV63.7, 80HSV53.7	531	220	210	80	461	255	227
100HSV65.5, 100HSV55.5	565	280	238	100	541	305	262
100HSV67.5, 100HSV57.5	565	280	238	100	541	305	262
100HSV611, 100HSV511	690	280	255	100	578	325	296
100HSV615, 100HSV515	710	280	255	100	578	325	296

Unit : mm

HSO / HSV

Hyosung Submersible Motor Pump

기술 사항(탈착장치) Technical (Detachment Device)



특징

- 1) 정기 점검시 오수,오물이 들어있는 수조에 들어가거나 토출배관을 분해하지 않고도 간단히 펌프를 인양, 설치가 가능
- 2) 펌프와 배관 접합면에서의 누수량이 적음

Features

- 1) During regular maintenance, the pump can be lifted and installed without entering the tank with wastewater, garbage or disconnecting the discharge pipe
- 2) Little leakage in the junction between pump and pipe

표준 사양 Standard Specifications

펌프형식 Pump Type		HSO			HSV		
탈착형식 Detachment Type		LS50	LM80	LL100	LS50	LM80	LL100
토출구경 Discharge Diameter		50	80	100	50	80	100
재질 및 규격 Material and Specification	탈착본체 Detachment Body	GC200			GC200		
	토출곡관 (후렌지) Discharge Bent Tube (Flange)	GC200			GC200		
	탈착후렌지 Detachment Flange	GC200			GC200		
	가이드 지지판 Guide Support	SS275			SS275		
	가이드레일 또는 파이프 (SGP) Guide Rail or Pipe (SGP)	L-Steel 40 X 40 X 5	25A	40A	L-Steel 40 X 40 X 5	25A	40A
	가이드 핀 Guide Pin	-	SM45C		-	SM45C	
	앵커볼트 자리 치수 Dimension of Anchor Bolt Position	M16-2 EA	M16-4 EA		M16-2 EA	M16-4 EA	
접속규격 Connection Specification	PT	KS 10K RF			PT	KS 10K RF	

※ GC200 : Cast Iron / SM45C : Carbon Steel / SS275 : Steel Structural

외형도 & 외형 치수표 Outline Drawing & Dimension

unit : mm

탈착형식 Detachment Type	구경 Diameter	펌프모델 Pump Model		출력 Power (kW)	펌프 및 탈착장치 치수 Dimensions of Pump and Detachment Device																	중량 Weight (kg)			
		60Hz	50Hz		A	B	C	D	E	F	G	H	J	K	L	M	N	O	P	Q	R	Pump	Detachment		
LS50	50	50HSO6.75	50HSO5.75	0.75	396	20	210	15	215	50	50	-	92	240	338	400	300	70	30	32	-	28	5		
		50HSO61.5	50HSO51.5	1.5	434																			235	
		50HSV6.75	50HSV5.75	0.75	420																				50
LM80	80	80HSO62.2	80HSO52.2	2.2	518	20	290	54	255	50	150	50	205	305	515	550	350	100	80	38	25A	66	15		
		80HSO63.7	80HSO53.7	3.7	543																				
		80HSV61.5	80HSV51.5	1.5	505																			65	265
		80HSV62.2	80HSV52.2	2.2	551																				
		80HSV63.7	80HSV53.7	3.7	576																			45	265
		80HSO65.5	100HSO55.5	5.5	656																				
LL100	100	100HSO67.5	100HSO57.5	7.5	681	106	356	85	365	165	55	-	210	435	675	800	500	180	150	50	40A	105	34		
		100HSO611	100HSO511	11	788																				
		100HSO615	100HSO515	15	808																				
		100HSV65.5	100HSV55.5	5.5	692																			127	407
		100HSV67.5	100HSV57.5	7.5	717																				
		100HSV611	100HSV511	11	824																				
		100HSV615	100HSV515	15	844																			110	407

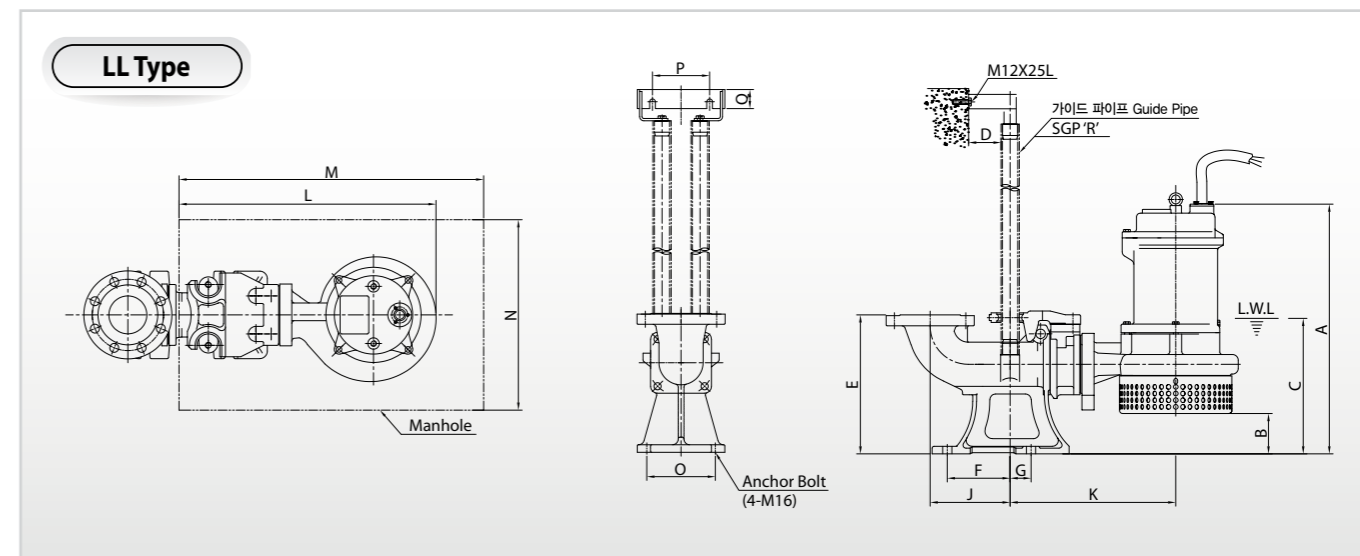
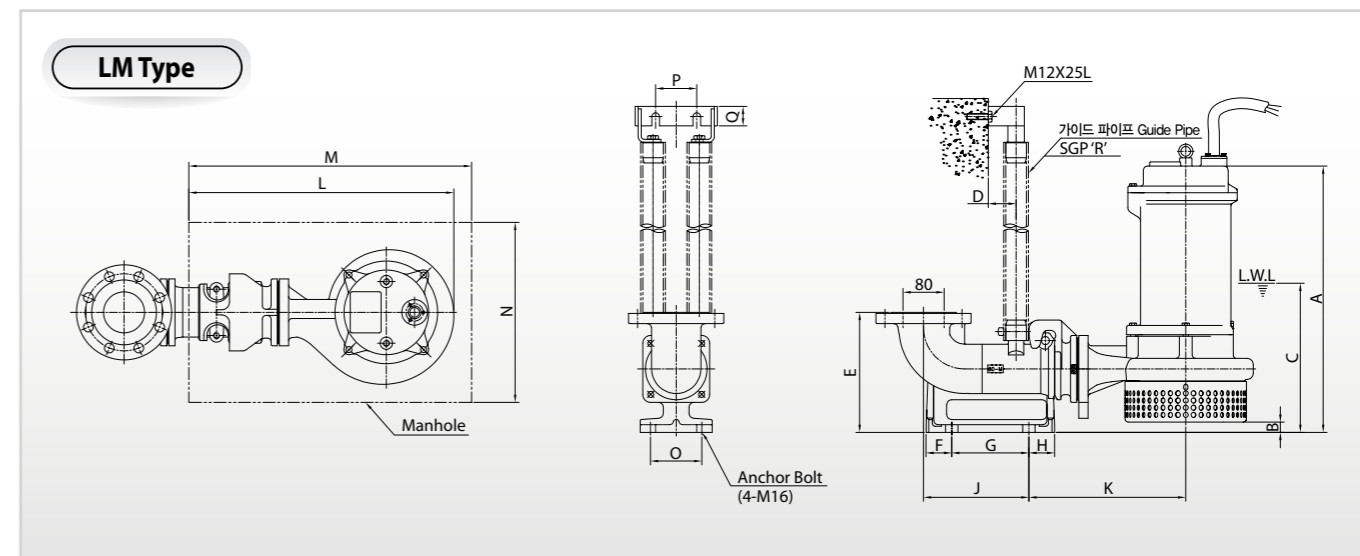
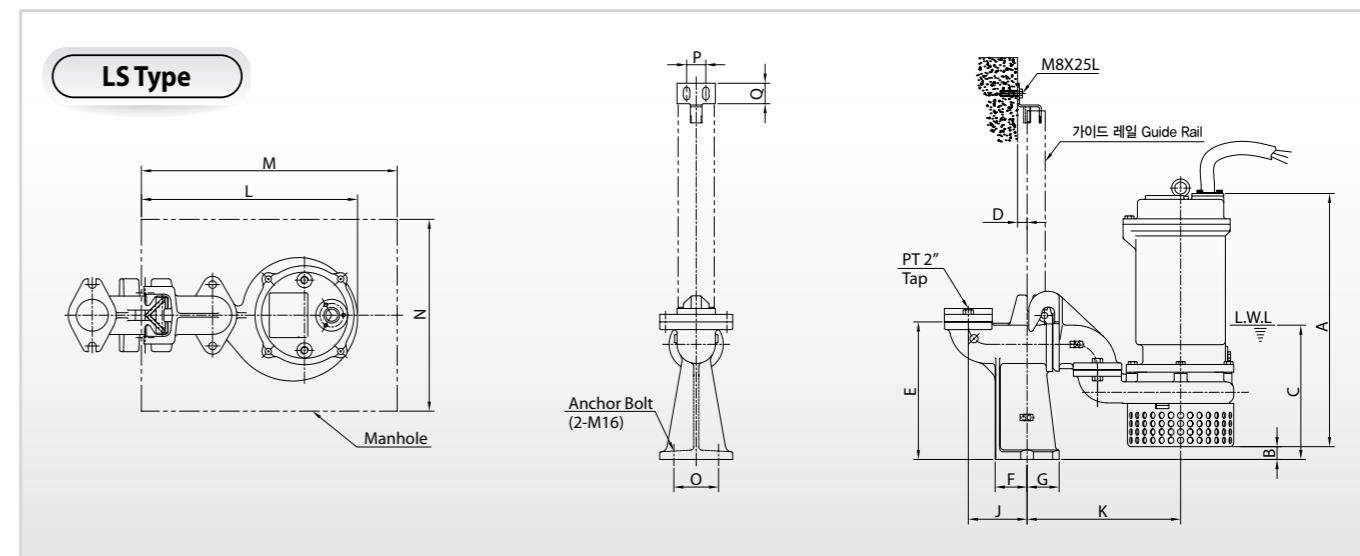

HSO / HSV

기술 사항(Auto Cut) Technical (Auto Cut)



Auto Cut

전동기의 권선위에 내장형으로 설치되어 과부하나 과열로 인한 전동기 소손을 방지하는 보호장치입니다.
The auto cut is installed on the wire of the motor to prevent the motor from overload or overheat.

구성 부품 Construction

Contacts	3 Sets
Snap Acting Disk	1 EA
Heater	3 EA
Terminals	3 EA
Adjusting Screw	1 EA
Housing	1 EA

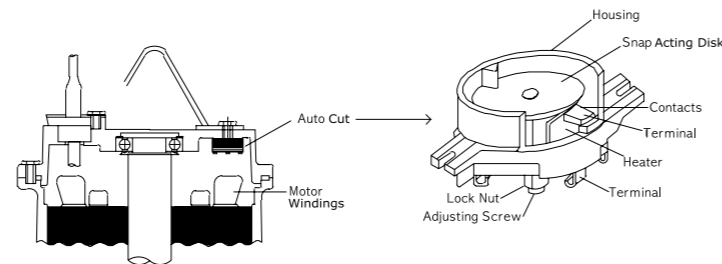

작동 원리

Auto Cut은 모터의 권선위에 설치되어 권선의 과열을 감지합니다.
[Fig. 1]은 정상운전상태(Closed Contact)의 Auto Cut을 나타냅니다. 실제온도가 한계치(120℃)에 도달하면, Snap Acting Disk가 [Fig. 2]와 같이 원형으로 뒤집어져 단락되고, 모터는 정지합니다. 모터온도가 안전운전온도(60℃)로 냉각되면, Snap Acting Disk가 [Fig. 1]과 같이 자동적으로 원위치 되고, 모터는 작동됩니다.

Operation

The auto cut is installed on the wire of the motor to detect wire's overheat. [Fig 1] is the auto cut in the normal mode (closed contact). When the temperature reaches its limit (120℃), the snap acting disk turns over as shown in [Fig. 2] to make a short circuit and stop the motor. Once the motor cools down to the safe operation temperature (60℃), the snap acting disk returns to its original position as shown in [Fig. 1] and the motor works.

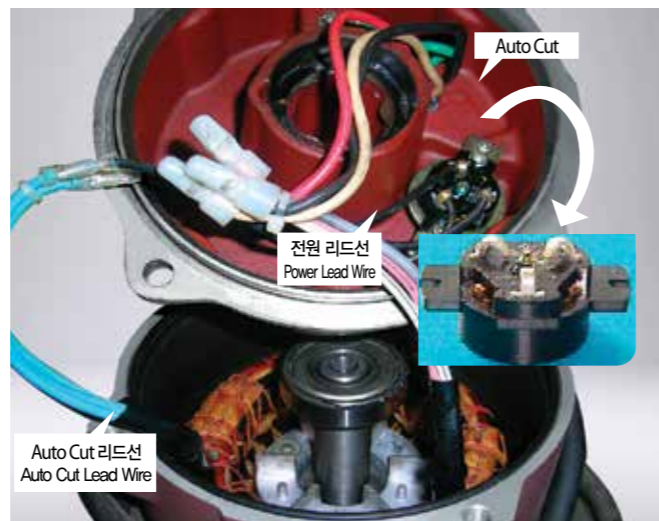

Fig. 1

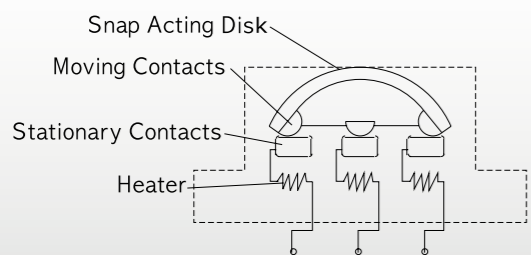
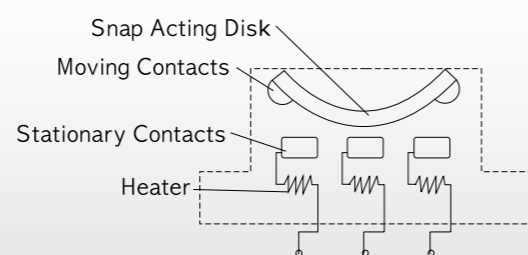

Fig. 2



HSE

Hyosung Submersible Motor Pump

용도 Application



배수용
Discharge



오수용
Slops



특징 Features

01. 고효율의 Semi-Open 회전자를 사용하여 사용범위가 넓고, 높은 효율을 발휘함
 02. Auto Cut을 부착하여 전동기의 과부하, 과열 등에 의한 전동기 소손 방지
 03. 흡입 스트레너 적용으로 고형물 유입 방지 및 회전자의 소손 방지
 04. 축봉부에 SiC재질의 고신뢰성 메카니칼 씰을 장착하여 전동기 내부로의 침수 방지
 05. 탈착장치 사용시 설치, 인양, 보수점검이 용이함
01. Highly-efficient semi-open impeller for wide application and high efficiency
 02. Auto cut to prevent the motor overload and stall
 03. Suction strainer to prevent solid intake and impeller damage
 04. Highly reliable SiC mechanical seal installed in the shaft to prevent water inflow to the inside of the motor
 05. Detachable type for easy installation, lifting and maintenance

호칭 Model Designation

50 HSE 6 1.5

토출구경 50 Discharge Diameter [mm]	펌프 모델명 HSE Model Name	주파수 6 Frequency [60Hz]	모터 동력 1.5 Motor Power [kW]
--	------------------------------------	-------------------------------------	---

표준 사양 Standard Specification

항목 Category	구경 Diameter		
	50	80 ~ 100	
액질 Liquid	취급액 Applicable Liquid	오수 (정화조 처리수) Waste Water 우수 Rainwater	
	온도 Temperature	0 ~ 40℃	
	이물질 최대크기 Maximum Size of Solid Matter	펌프 토출구경 10% 정도의 고형물 10% of the Discharge Diameter	
회전수 R.P.M	3500		
회전방향 Rotation Direction	CW (구동기 측에서 펌프를 바라보았을 때) (From the Motor Side to the Pump)		
모터 Motor	상/전압 Phase / Voltage	3Φ / 380V	
	주파수 Frequency	50, 60Hz	
	절연등급 Insulation	IP68	
	기동방식 Starting Type	직기동 Direct	
축봉장치 Shaft Seal	Double Mechanical Seal		
배관 접속규격 Piping Connection	KS 10K FF		
전동기 보호장치 Motor Protection Device	Auto Cut		
체인 / 케이블 Chain / Cable	5m (SWRM8) / 6m		

선택사양 Option

- 접액부 재질 (조립단면도 선택사양 참고)
 - 전동기 형식 (요구사항)
 - 축봉장치 (요구사항)
 - 각종 계기류, Drain/Vent 배관 구성
 - 도장사양 (요구사항)
 - 회전차 재질(SSC13)
- Material of the Liquid Contacting Part (Refer to the Specifications in the Sectional Drawing)
 - Motor Type (Requirement)
 - Shaft Seal (Requirement)
 - Instrument, Drain/Vent Piping
 - Painting (Requirement)
 - Material of Impeller (SSC13)

선택도 Selection Chart

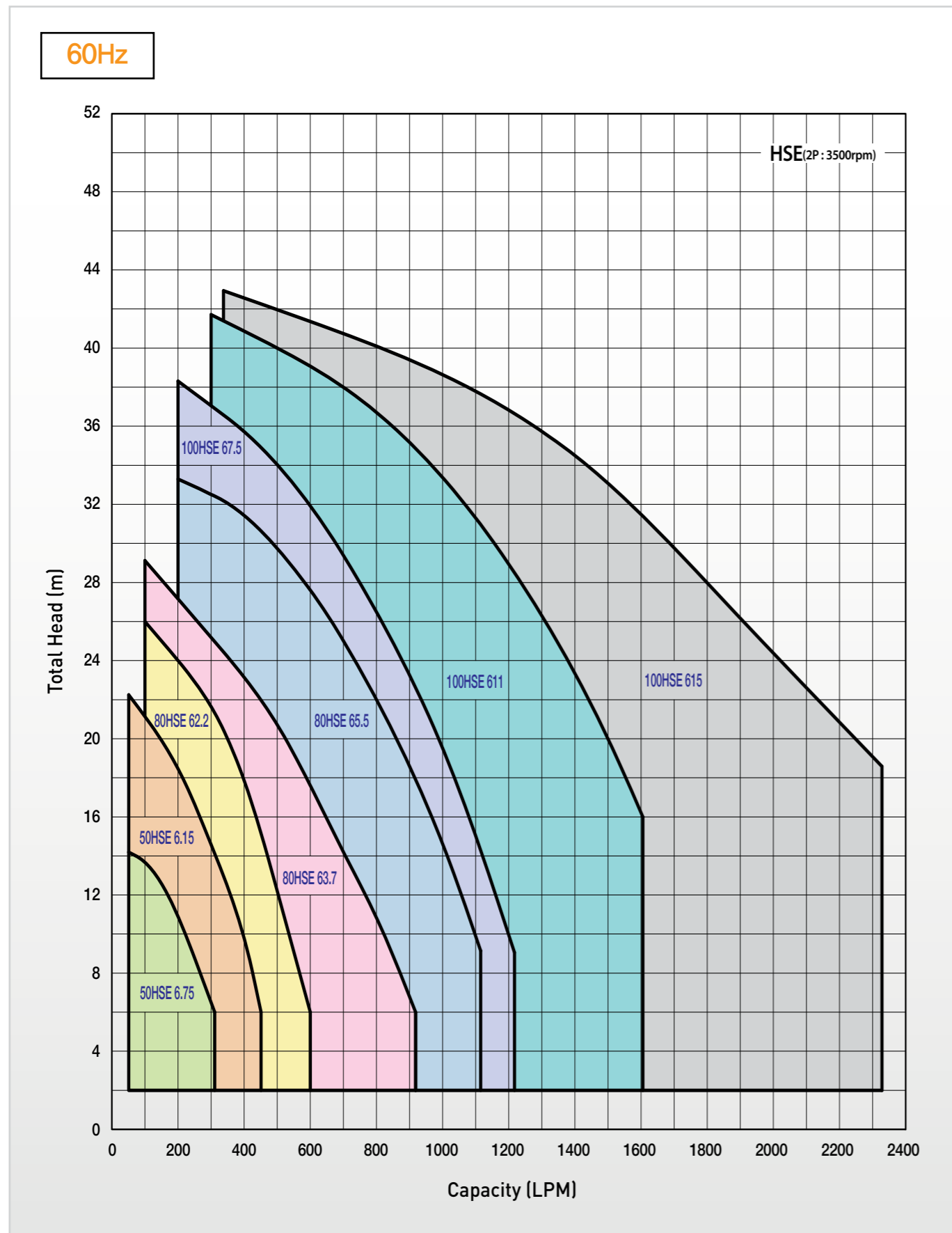

조립 단면도 Sectional Drawing

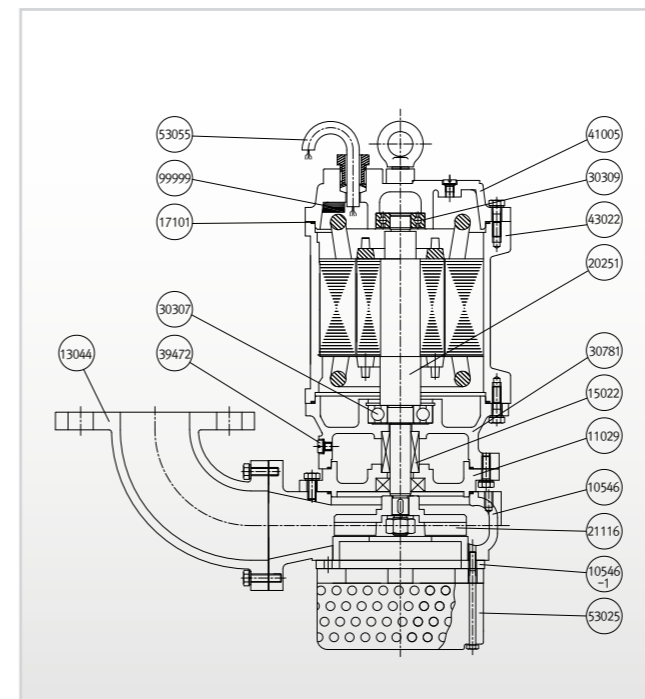

부품번호 Part No.	부품명 Part Name	표준재질 Standard Material	선택사양 Option
10546	Casing	GC200	-
10546-1	Suction Cover	GC200	SSC13
11029	Bracket	GC200	-
13044	Elbow	GC200	-
15022	Mechanical Seal	SiC/SiC	-
17101	O-Ring	N.B.R	-
20251	Shaft	STS410	-
21116	Impeller	GC200	-
30307	Ball Bearing	-	-
30309	Ball Bearing	-	-
30781	Bearing Housing	GC200	-
39472	Plug	SM25C	-
41005	Motor Cover	GC200	-
43022	Motor Frame	GC200	-
53025	Strainer	SS275	-
53055	Cable	-	-
99999	Auto Cut	-	-

※ GC200 : Cast Iron / SM25C : Carbon Steel / STS410 : Stainless Steel / SS275 : Steel Structural

외형도 & 외형 치수표 Outline Drawing & Dimension

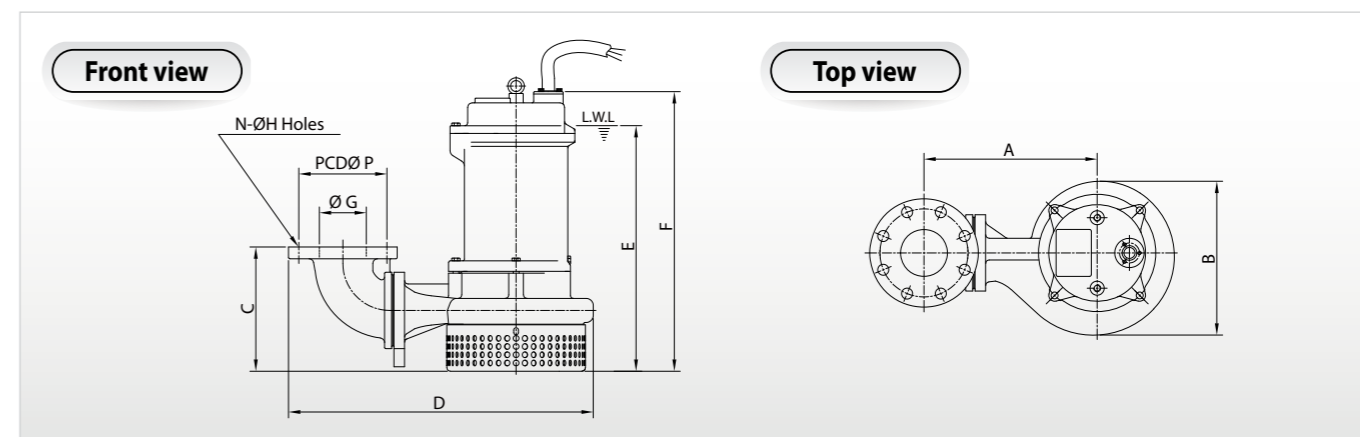

unit : mm

Model	Power (kW)	Pump & Motor Dimensions (mm)										Flange Spec. (Discharge)	중량 Weight (kg)	Elbow
		A	B	C	D	E	F	G	N	H	P			
50HSE6.75	0.75	210	180	170	380	320	370	50	4	19	120	KS 10K.F.F 50A	26	9
50HSE6.15	1.5	220	210	190	390	390	430	50	4	19	120	KS 10K.F.F 50A	32	
80HSE62.2	2.2	240	200	225	440	420	460	80	8	19	150	KS 10K.F.F 80A	41	13
80HSE63.7	3.7	290	260	240	500	520	580	80	8	19	150	KS 10K.F.F 80A	71	
80HSE65.5	5.5	280	260	240	500	520	580	80	8	19	150	KS 10K.F.F 80A	72	20
100HSE67.5	7.5	340	310	290	610	690	850	100	8	19	175	KS 10K.F.F 100A	126	
100HSE611	11	340	310	290	610	690	850	100	8	19	175	KS 10K.F.F 100A	140	
100HSE615	15	340	310	290	610	720	870	100	8	19	175	KS 10K.F.F 100A	140	

기술 사항(탈착장치) Technical (Detachment Device)



특징

- 1) 정기 점검시 오수,오물이 들어있는 수조에 들어가거나 토출배관을 분해하지 않고도 간단히 펌프를 인양, 설치가 가능
- 2) 펌프와 배관 접합면에서의 누수량이 적음

Features

- 1) During regular maintenance, the pump can be lifted and installed without entering the tank with wastewater, garbage or disconnecting the discharge pipe
- 2) Little leakage in the junction between pump and pipe

표준 사양 Standard Specifications

펌프형식 Pump Type		HSE		
탈착형식 Detachment Type		LS50E	LM80E	LL100E
토출구경 Discharge Diameter		50	80	100
재질 및 규격 Material and Specification	탈착본체 Detachment Body	GC200		
	토출곡관 (후렌지) Discharge Bent Tube (Flange)	GC200		
	가이드 지지판 Guide Support	GC200		
	가이드레일 또는 파이프 (SGP) Guide Rail or Pipe (SGP)	25A	32A	
	가이드 핀 Guide Pin	SM45C		
	앵커볼트 자리 치수 Dimension of Anchor Bolt Position	M12 - 4EA	M16 - 6EA	
	접속규격 Connection Specification	KS 10K FF		

※ GC200 : Cast Iron / SM45C : Carbon Steel

외형도 & 외형 치수표 Outline Drawing & Dimension

unit : mm

탈착형식 Detachment Type	구경 Diameter	펌프모델 Pump Model	출력 Power (kW)	펌프 및 탈착장치 치수 Dimensions of Pump and Detachment Device																중량 Weight (kg)	
				A	B	C	D	E	F	G	J	K	L	M	N	O	P	Q	R	Pump	Detachment
LS50E	50	50HSE6.75	0.75	420	50	370	85	210	74	124	35	200	315	370	300	100	215	40	25A	26	17
		50HSE61.5	1.5	510		440						210	345	390	300					32	
LM80E	80	80HSE62.2	2.2	490	30	450	85	250	100	150	20	200	355	410	300	100	215	40	25A	41	27
		80HSE63.7	3.7	600	20	540						250	425	480	360					71	
		80HSE65.5	5.5	605	20	540						250	415	470	360					71	
LL100E	100	100HSE67.5	7.5	870	40	710	100	315	154	180	45	315	490	540	400	130	255	45	32A	126	38
		100HSE611	11	890		730						315	490	540	400					140	
		100HSE615	15	910		760						315	490	540	400					140	

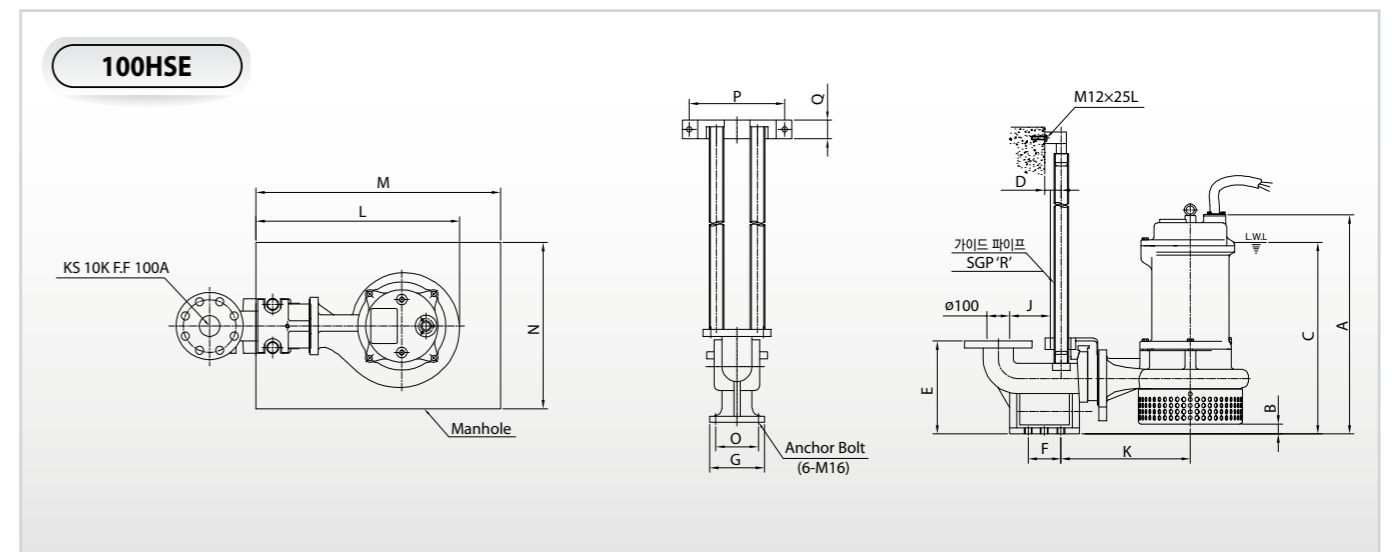
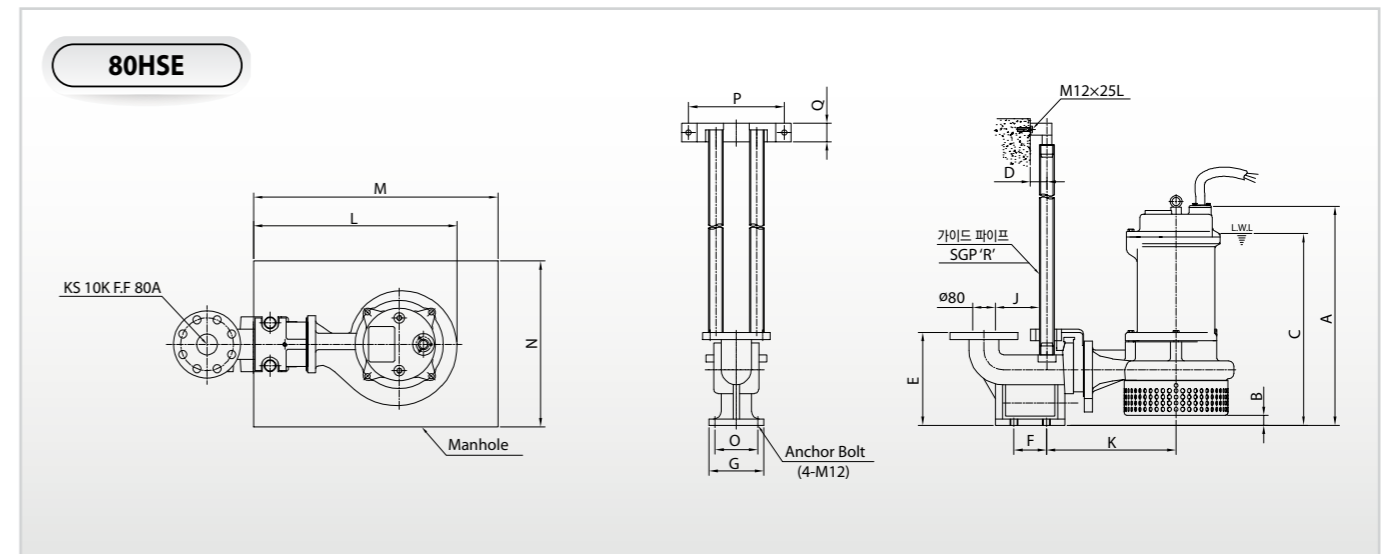
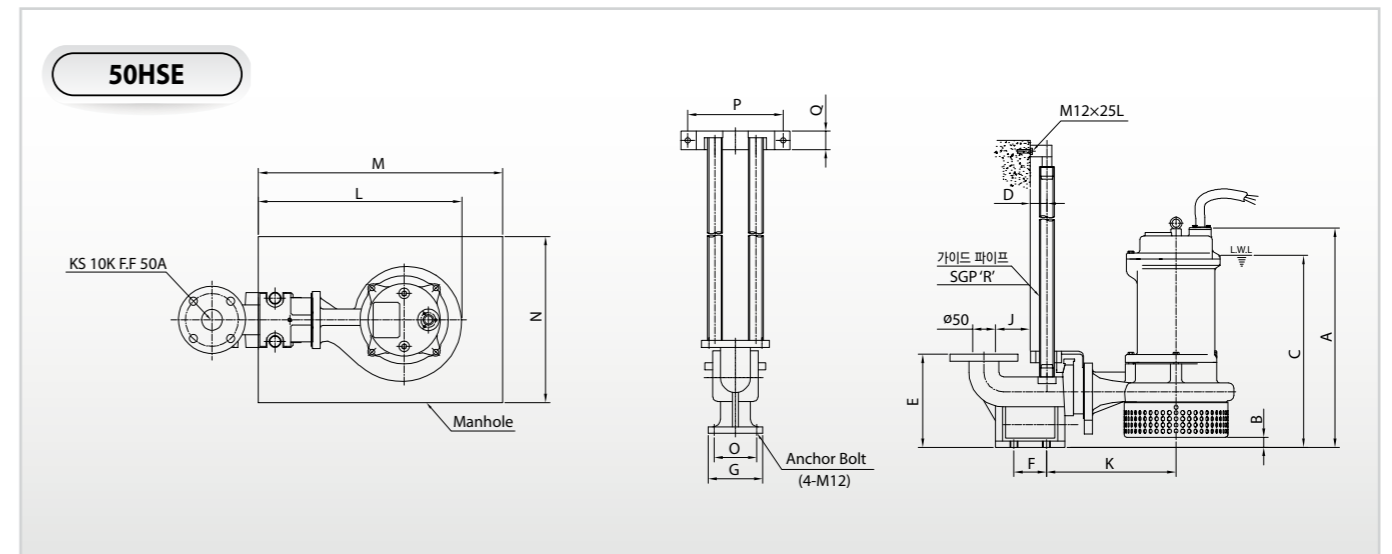

HSE

Hyosung Submersible Motor Pump

기술 사항(Auto Cut) Technical (Auto Cut)



Auto Cut

전동기의 권선위에 내장형으로 설치되어 과부하나 과열로 인한 전동기 소손을 방지하는 보호장치입니다.
The auto cut is installed on the wire of the motor to prevent the motor from overload or overheat.

구성 부품 Construction

Contacts	3 Sets
Snap Acting Disk	1 EA
Heater	3 EA
Terminals	3 EA
Adjusting Screw	1 EA
Housing	1 EA

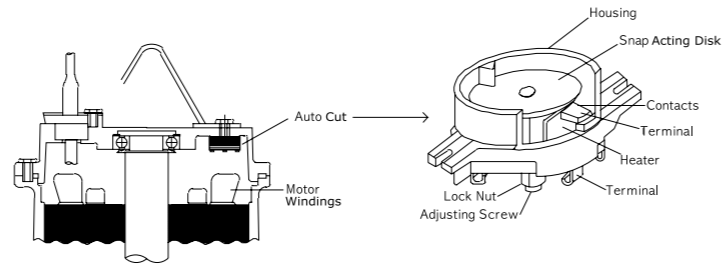

작동 원리

Auto Cut은 모터의 권선위에 설치되어 권선의 과열을 감지합니다.
[Fig. 1]은 정상운전상태(Closed Contact)의 Auto Cut을 나타냅니다. 실제온도가 한계치(120℃)에 도달하면, Snap Acting Disk가 [Fig. 2]와 같이 원형으로 뒤집어져 단락되고, 모터는 정지합니다. 모터온도가 안전운전온도(60℃)로 냉각되면, Snap Acting Disk가 [Fig. 1]과 같이 자동적으로 원위치 되고, 모터는 작동됩니다.

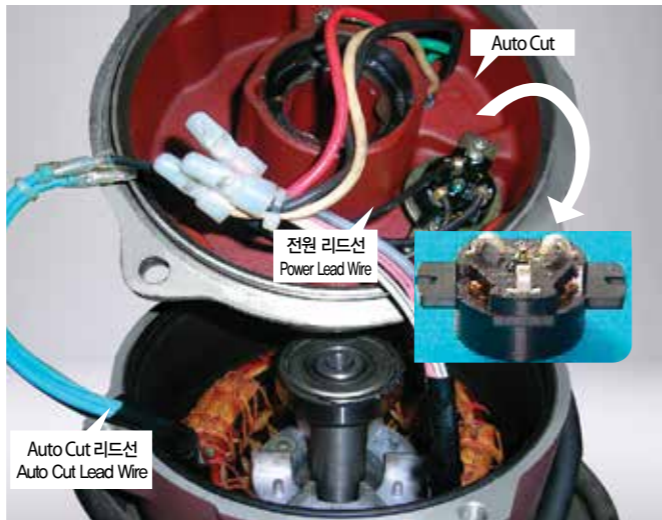

Operation

The auto cut is installed on the wire of the motor to detect wire's overheat. [Fig 1] is the auto cut in the normal mode (closed contact). When the temperature reaches its limit (120℃), the snap acting disk turns over as shown in [Fig. 2] to make a short circuit and stop the motor. Once the motor cools down to the safe operation temperature (60℃), the snap acting disk returns to its original position as shown in [Fig. 1] and the motor works.

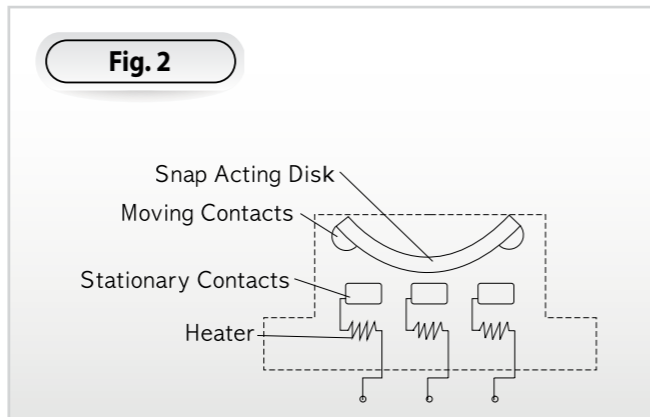
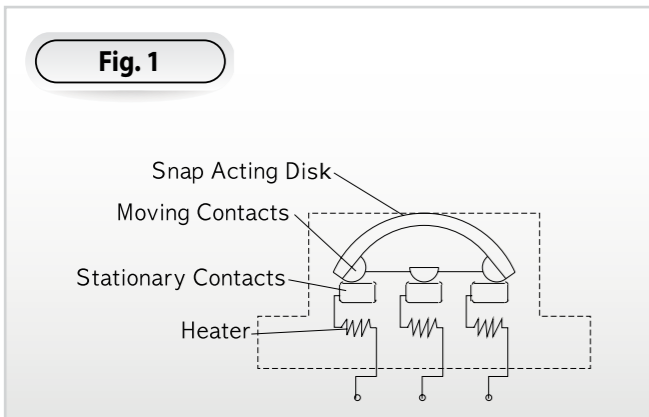

HSO / HSV / HSE

Hyosung Submersible Motor Pump